

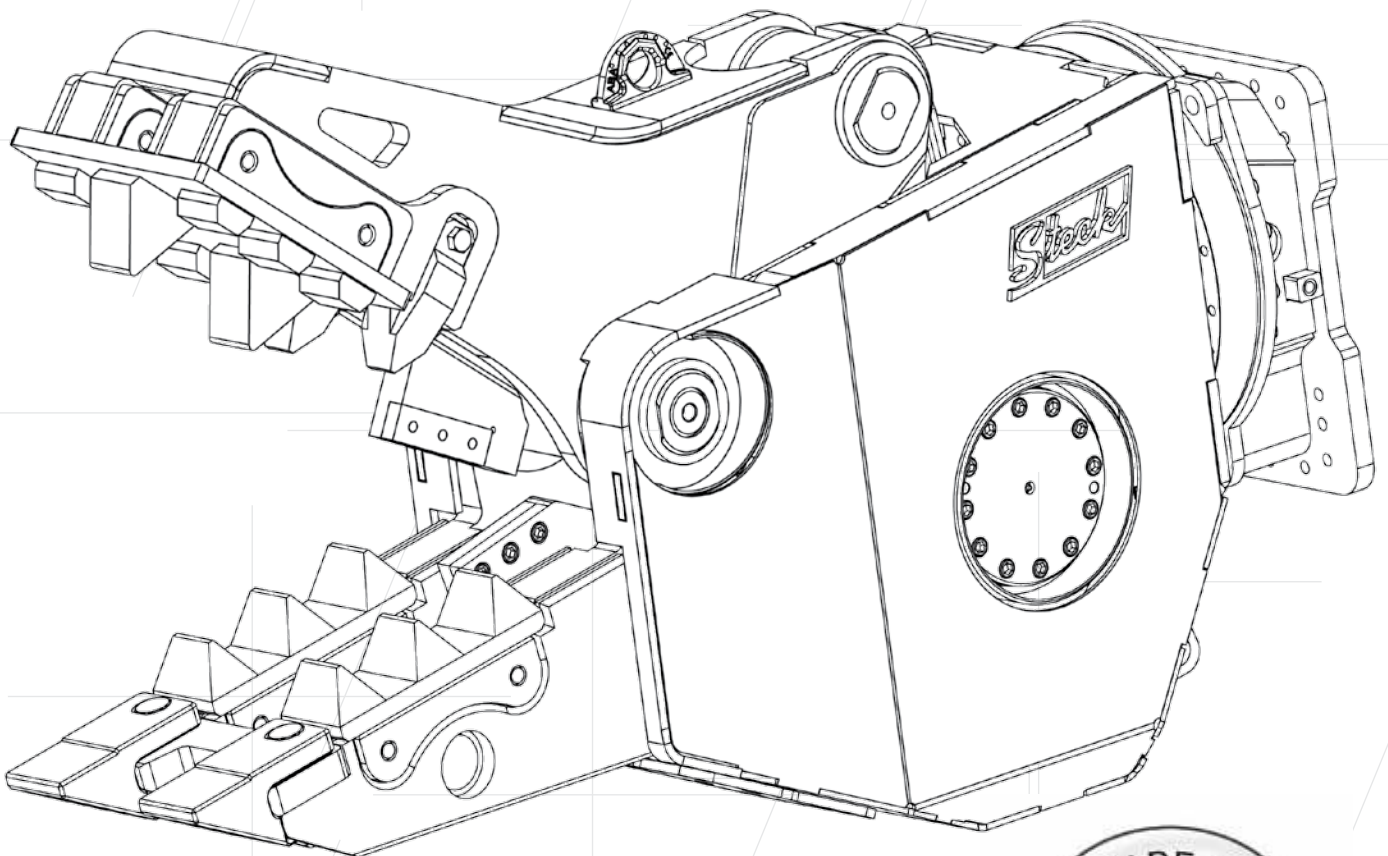

Pulverizer

Long Front



Demolition technique by Steck:

Innovative technique with well thought out type designation.



① ② ③

P 20 R

Long Front

④

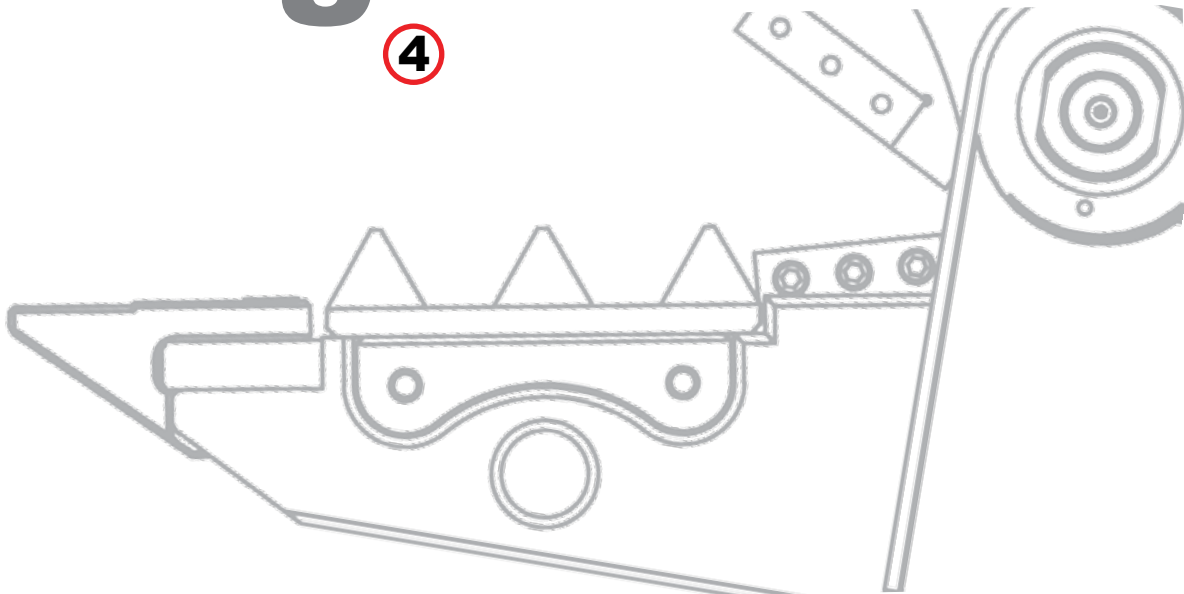

- ① Abbreviation type of device, first letter of english term: **P**ulverizer
- ② Net weight in tons, multiplied by 10, rounded
- ③ Optional additional information: **U**niversal
Rotating
- ④ Particularly suitable for long front excavator



The rotation pulverizer long front made by Steck

- developed for the separation of reinforcing bars from the concrete
- with hydraulic turning device
- Cost reduction of investment
- higher productivity

Convince with:

Short cycle time

- extremely large rotary feed through
- specific speed valve
- large sized hydraulic components
- oil circuit without backpressure

Easy maintenance

- replaceable wear parts
- crusher teeth, cutter teeth and blades rotatable
- side arms protected by additional side protection
- modular design
- central lubrication system optional
- on- site replacing of wear parts possible

Improvement of cutting forces

- 25% higher clamp force / closing force
- powerful hydraulic cylinder
- optimization of flow of forces
- ideal power transmission in conjunction with shear construction

Easy handling

- low net weight
- weight reduction by more than 20%
- head plate straight or bevelled (selectable)

Long lasting product

- wear parts made of highly wear resistant casting
- shear arms with special side wear protection
- piston rod and bearing eye made of one- piece
- new form-locking innovative construction.
- the point loading reduction by more than 40%

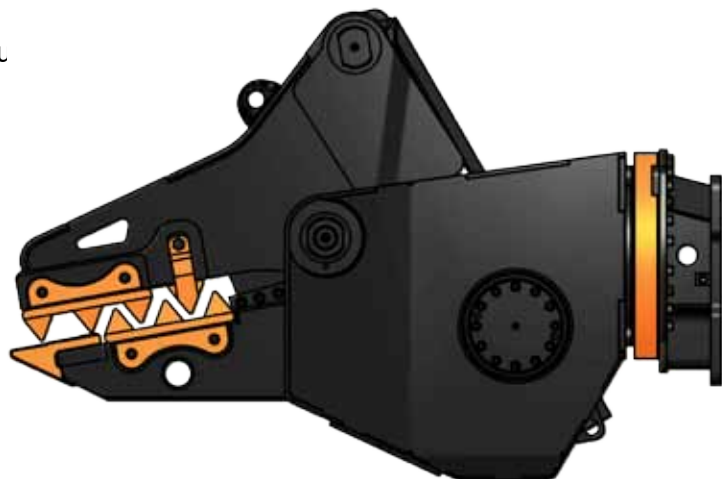

New design of pulverizer long front:

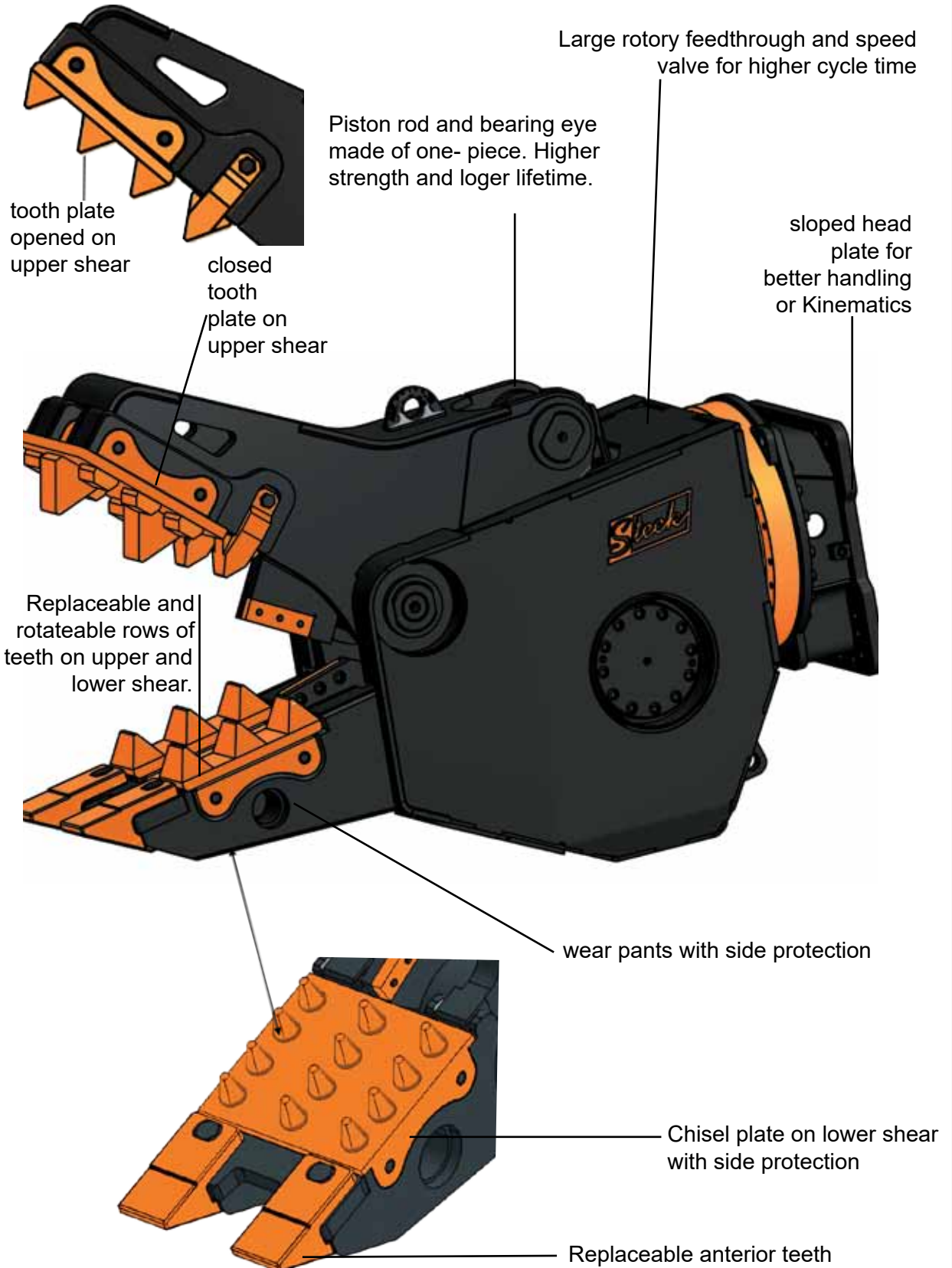

Pulverizer Long Front

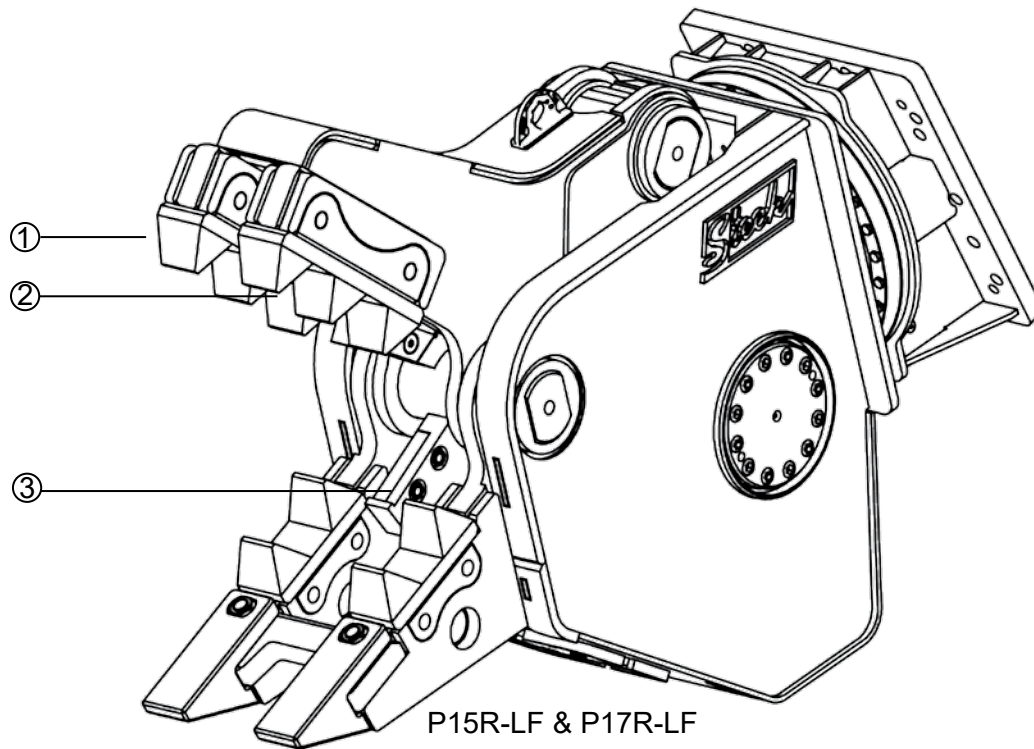

Technical details	P15R - LF	P17R - LF	P20R - LF	P25R- LF
operating weight (t)	12 - 17	13 - 24	15 - 28	22 - 30
weight without head plate (kg)	1.500	ca. 1.760	1.920	2.530
opening / closing (sec)	1,6 - 1	1,6 - 1	1,7 - 1,2	1,9 - 1,3
opening / closing (l/min)	200 - 300	200 - 300	200 - 500	200 - 500
rotate (l/min)	40 - 60	40 - 60	40 - 60	40 - 60
opening / closing P ^{max} (bar)	350	350	350	350
rotate P ^{max} (bar)	140	140	140	140
overall height (mm)	1.850	ca. 1.850	2.070	2.270
overall width (mm)	650	ca. 650	720	720
jaw opening (mm)	750	850	860	875
jaw depth (mm)	580	ca. 700	620	780
width lower jaw (mm)	380	ca. 400	400	440
width higher jaw (mm)	300	ca. 320	320	350
cutting length (mm)	150	ca. 150	200	200
closing force in 1 (t)	72	83	90	105
closing force in 2 (t)	99	119	126	130
closing force in 3 (t)	162	185	189	228

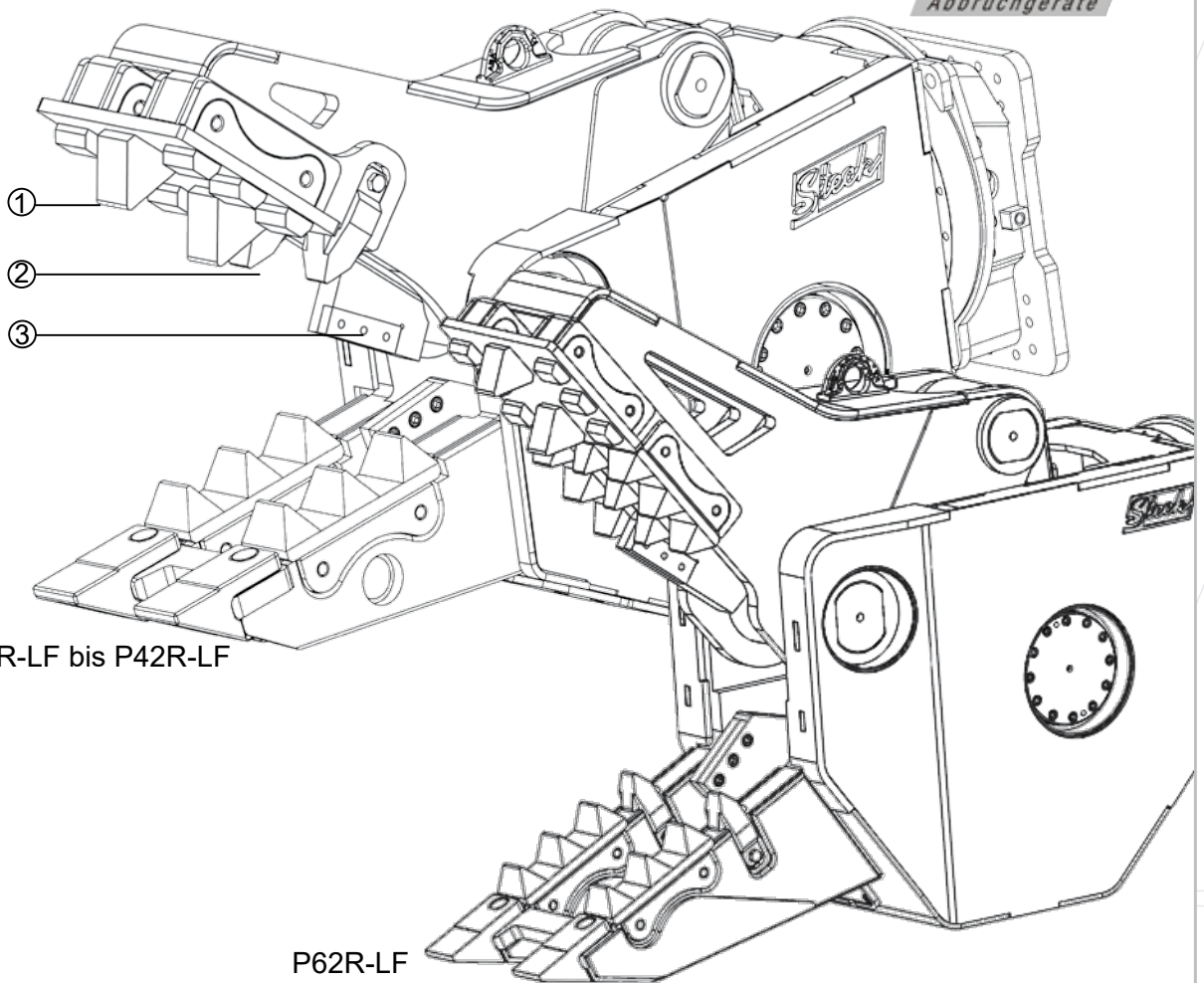

Technical details	P28R- LF	P32R- LF	P42R- LF	P62R- LF
operating weight (t)	27 - 36	30 - 45	42 - 65	60 - 85
weight without head plate (kg)	2.830	3.180	4.150	6.200
opening / closing (sec)	1,9 - 1,3	2,6 - 2	2,3 - 2,5	2,8 - 3,0
opening / closing (l/min)	200 - 500	200 - 500	300 - 500	450 - 550
rotate (l/min)	40 - 60	40 - 60	40 - 60	50
opening / closing P ^{max} (bar)	350	350	350	350
rotate P ^{max} (bar)	140	140	140	170
overall height (mm)	2.270	2.440	2.504	2.850
overall width (mm)	720	720	720	840
jaw opening (mm)	900	1.000	1.200	1.500
jaw depth (mm)	885	945	1.070	1.200
width lower jaw (mm)	490	525	565	620
width higher jaw (mm)	350	400	450	600
cutting length (mm)	200	250	250	250
closing force in 1 (t)	115	140	155	185
closing force in 2 (t)	155	173	195	210
closing force in 3 (t)	309	368	380	480

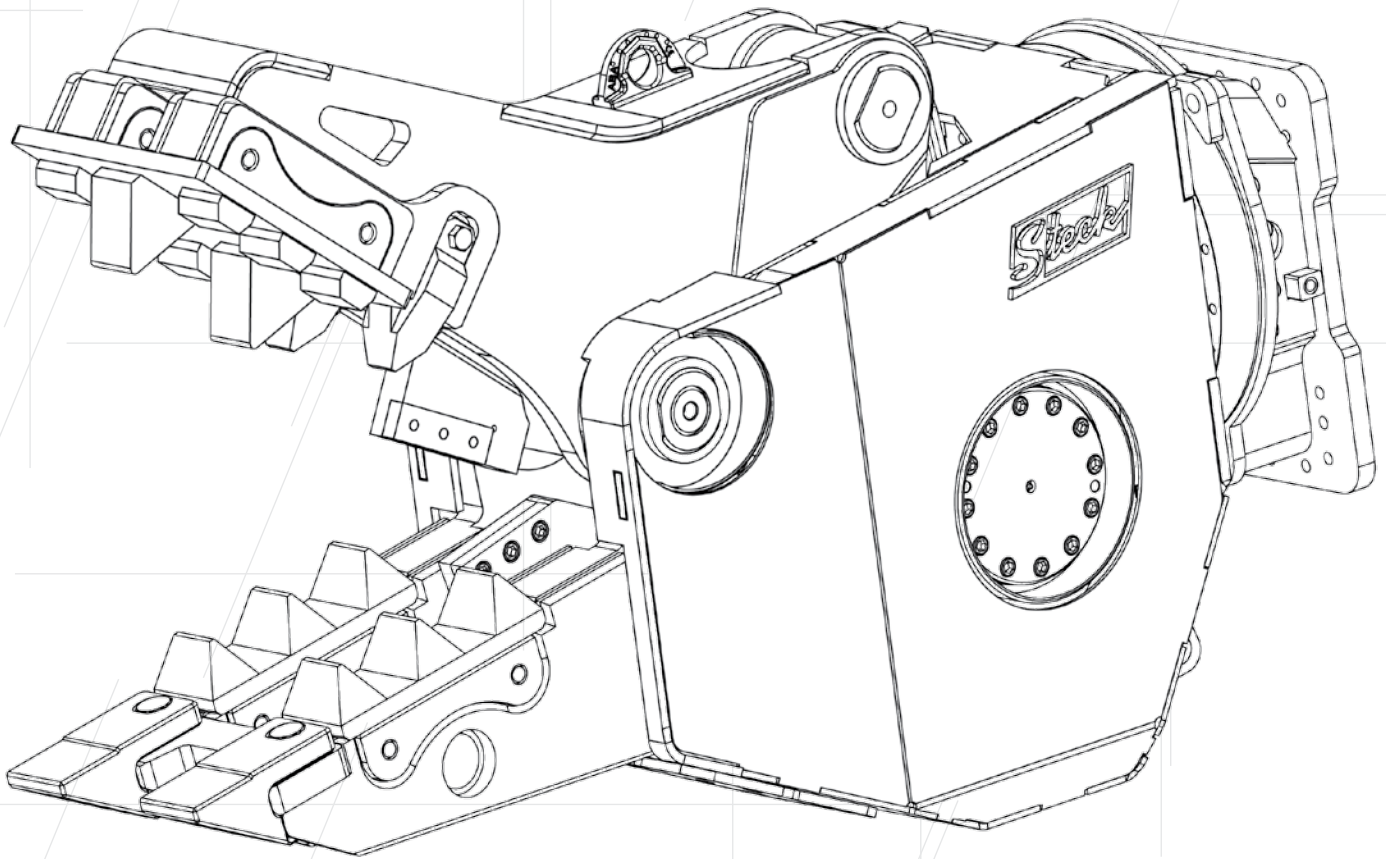

Steck Abbruchgeräte GmbH
Hauptstr. 20
D- 89192 Rammingen

place of jurisdiction: Ulm/Donau HRB 726131
VAT- ID No.: DE275269830
phone +49 (0) 7345 9123 - 0
fax +49 (0) 7345 9123 - 20
mail info@steck.de
internet www.steck.de

your contact person:

Empty dashed box for contact person information.